

MEETING ROOMS AND CAPACITIES

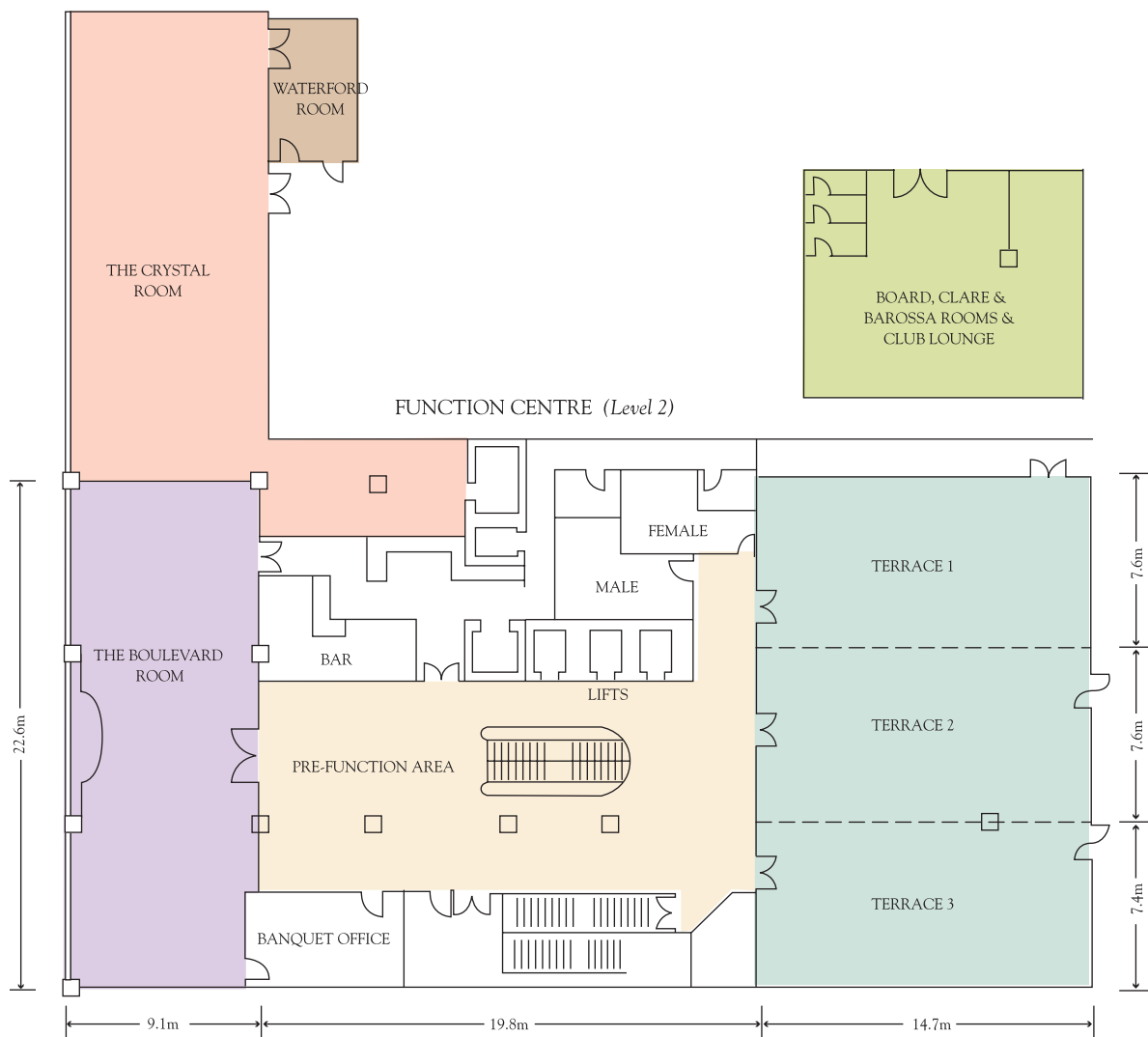

Conference Room Names: (maximum capacities and accurate)	Height	Area m2	Theatre	Classroom	Banquet	U Shape	Cocktails	Boardroom	Cabaret (Open Rounds)
Terrace Rooms (each)	(W) 2.8m	112	100	30	80	30	100	30	64
Terrace 1/2	(W) 2.8m	219	250	100	160	45	250	30	128
Terrace 1/2/3	(W) 2.8m	328	350	120	270		350		216
The Boulevard	(W) 3.3m	206	200	80	170	50	200	50	136
The Crystal Room	(W) 2.8m	205	150	60	120	50	150	40	60
Waterford Private Room	(W) 2.6m	28			20			20	
Boardroom (Level 5)	(W) 2.3m	100	40					20	
Clare Room (Level 6)	(W) 2.3m	100	40	24	40	25	40	20	32
Barossa Room (Level 7)	(W) 2.3m	100	40	24	40	25	40	20	32
Club Lounge (Level 8)	(W) 2.8m	100	30	20	30	15	40	20	24
Chairman's Lounge	(W) 2.3m	38						8	

(W) – wheelchair access available



TECHNICAL FEATURES

- Audio Visual Company ~ onsite
- Individually controlled air-conditioning in all rooms
- Light dimmers in all rooms
- 5 (2m x 3m) exhibitor booth capacity in pre-function area
- 1 – 2 PABX lines in all rooms
- ISDN lines for video and audio conferencing
- Fully integrated sound system in Terrace Ballroom, Boulevard Room and Crystal Room
- Service lifts 2.45m high x 2.00m wide x 1.56m deep

CONFERENCE FEATURES

- 10 rooms catering from 2 to 350 people
- The Ballroom is 328m<sup>2</sup>
- Natural light to some rooms
- Access to outdoor areas
- The magnificent Crystal Room offers private lift access